

The ELECTRO-HYDRAULIC control device is used to check the condition of the axles of 3,500 kg MMA light vehicles. It allows to observe the possible wear and tear caused by them.

Two test plates installed on the floor at ground level are guided in their longitudinal and transversal movements by the switches mounted on the hand lamp.

The latest technologies have been used to create this equipment, allowing a maximum accuracy in finish, achieving a strong machine with excellent appearance and with silent and precise functioning.

Standard Equipment

- 1 electro-hydraulic play detector with 4 movements
- 1 electro-hydraulic play detector with 2 movements
- Hydraulic group
- Electric box
- Wired control torch

Technical Data

Maximum axle load	4 Tn.
Motor	2,2 Kw
Voltage	230 - 400 V. 50 Hz. Threephasic
Thermal Protector	10 A
Protection Fuse	3 A
LED Lamp	12 V / 6 W
Tank capacity hydraulic unit	15 L. SAE-10 oil
Hydraulic Pump	15 L. /minute
Power force	12.500 N
Max. Side movement	100 mm.
Stroke speed	26 cm / s
Wired lamp operation and control	

Operation **Electro Hydraulic**

Max load per axle **4 Tn.**

Motor **2,2 Kw**

Hydraulic Pump **15 l. / minute**

Mechanics



Epoxy Paint

Powder-coated finish ensures optimal and long-lasting protection

Perfect Fit Assembly

Mechanical design using Perfect-Fit, which guarantees the assembly and perfect final finish on all our equipment



Dimensions

Plate Dimensions	650 x 650 x 160 mm.
Packed equipment dimensions	1.150 x 845 x 930 mm.
Plate weight (unit)	132 Kg
Packed equipment weight	295 Kg

Longitudinal and transverse movement of the left plate and longitudinal movement of the right plate

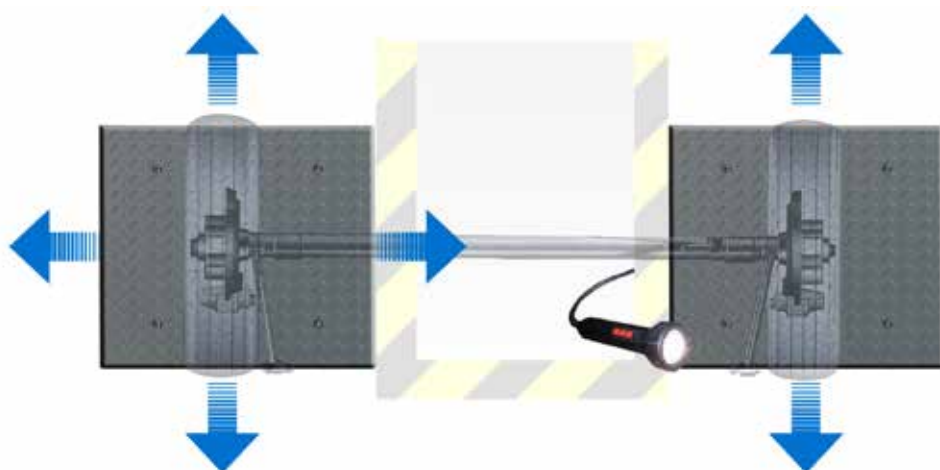

Optional Equipment



DHL-PGH Pupitre Hydraulic group
Dimensions: 420 x 550 x 1.460 mm.
Weight 92 Kg

DHL-230 Power supply 230 V. Threephasic



DH-LI Wireless control LED flashlight with rechargeable lithium battery.

CIM-DHL-01 Civil work frame

GEN-40LRH 40 m. hydraulic hose assemblies and fittings